



# Astell Kern Acro BE100 Bluetooth Wireless Speaker User Guide

February 18, 2022February 19, 2022

[Home](#) » [Astell&Kern](#) » Astell Kern Acro BE100 Bluetooth Wireless Speaker User Guide 📄

# Astell&Kern

INSTRUCTION BOOK

User Guide  
ACRO BE100



## Contents [ [hide](#) ]

- [1 Before Using the Product](#)
- [2 Included Items](#)
- [3 Parts Names](#)
- [4 Power Management](#)
- [5 Connections](#)
- [6 Basic Operations](#)
- [7 Listening to Music](#)
- [8 Listening to Radio](#)
- [9 Safety Precautions](#)
- [10 Troubleshooting](#)
- [11 Copyright](#)
- [12 Certifications](#)
- [13 Registered Trademarks](#)
- [14 Disclaimers](#)
- [15 Specifications](#)
- [16 Documents / Resources](#)
  - [16.1 Related Manuals / Resources](#)

## Before Using the Product

The descriptions contained in this instruction book are based on the product's default settings.

The content of this user guide may differ from that of the actual product depending on the manufacturer's specification changes, and the picture in the user guide may differ from that of the actual product.

Some features may not be available depending on the manufacturer or model of the mobile device.

Please check with the manufacturer of the mobile device.

Failures due to liquid damage are not covered by warranty.

## Included Items

Components may change without previous notice to improve the performance or quality of the product.

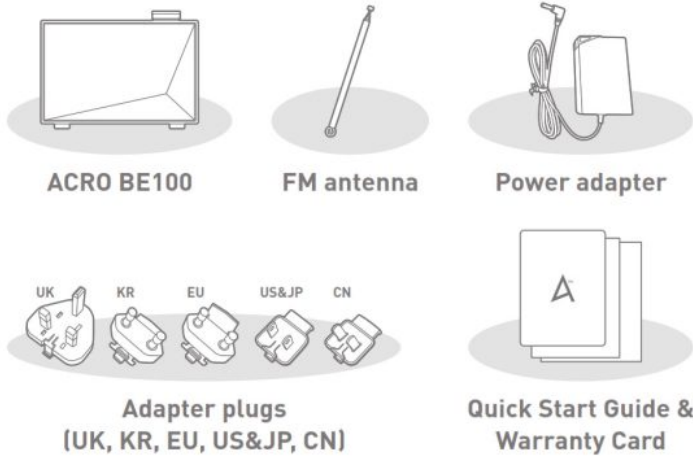

**FM antenna:** Receive FM broadcasts.

**Power adapter:** Supplies power to the product.

**Adapter plugs:** Different plugs for country-specific use.

**Quick Start Guide:** A basic guide for using the product.

**Warranty Card:** Please keep the warranty card, since it is required when requesting after-sales service.

**Product User Guide:** The User Guide can be downloaded from the Astell&Kern website: [<http://www.astellkern.com> Support > Download].



FM radio functions may vary depending on the model.

## Parts Names

The appearance of the product as well as the information printed and engraved on the product may vary depending on the manufacturer's

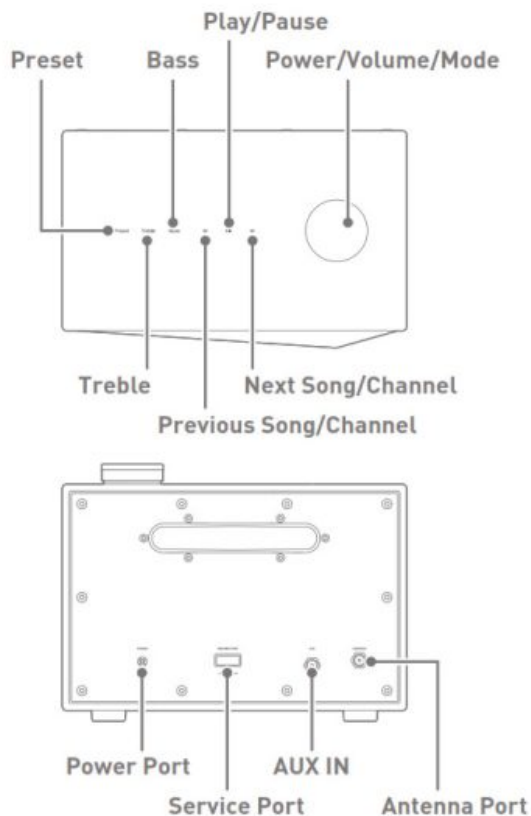

specifications.

**Preset:** You can save up to 6 radio channels of your choice.

**Bass:** Adjust the bass level.

**Play/Pause:** Play or pause playback.

**Power/Volume/Mode:**

Long press – Turn ON/OFF the product.

Short press – Change the mode.

Turn the wheel to adjust the sound volume.

**Treble:** Adjust the treble level.

**Previous Song/Channel:** Go to the previous song/ channel.

**Next Song/Channel:** Go to the next song/channel.

**Power Port:** Use this port to connect the power adapter to supply power to the device.

**Service Port:** Use this port for after-sales service.

**AUX IN:** Use this port to connect to an external device to output its sound.

**Antenna Port:** Use this port to connect the antenna.



FM radio functions may vary depending on the model.

The service port is used for after-sales service only.

Using the product with the service port cover removed can cause product failure.

The front cover of the speaker cannot be removed. Never remove the cover. Doing so can cause damage to the speaker unit.

The warranty does not cover defects caused by the customer's negligence.

## Power Management

Connecting the adapter and the plug

1. Remove the adapter by pressing the bottom of the cover and lifting it up.

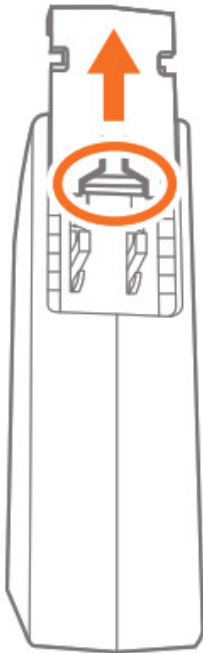

2. Select the appropriate plug for your country and slide it down until it clicks in place.

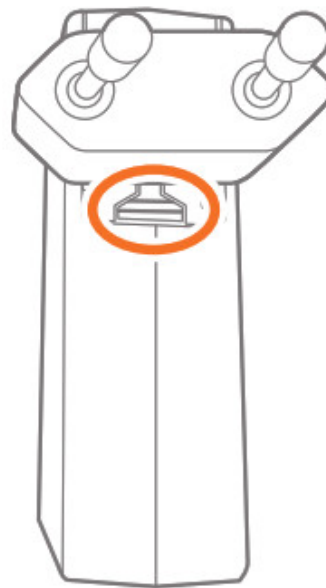
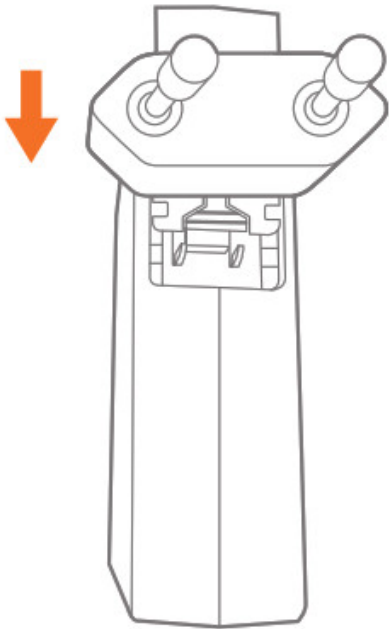

3. Change the plug by pressing the bottom and lifting it up.

**!** Avoid pushing the plug too hard. Doing so can damage it. Check the direction carefully before engaging it. Make sure to connect the type of plug that fits your country's outlet.

### Connecting Power

1. Connect the included adapter to the [Power] port on the back of the product.
2. Select the appropriate plug for your country, connect it to the adapter, and then connect it to the outlet to supply power to the product.

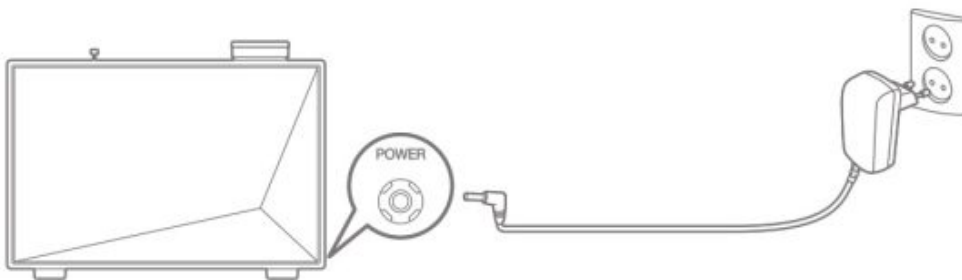

**!** Power adapter specifications: 19V / 3.43A  
Be sure to use the power adapter that comes with the product. Adapters that do not meet the product's specifications may cause product failure.  
Moisture on the power port can cause product failure. Be sure to completely remove any moisture from the power port before using it.

Make sure to connect the plug that fits the outlet type used in your country.  
 The adapter may get hot while in use. This is normal and does not affect the life or function of the product.  
 Charging the product when the adapter jack is wet can damage the product. Dry it thoroughly before charging.  
 Avoid bending the adapter jack excessively. Doing so may cause the power cable to break.  
 Always unplug the power cable from the outlet before disconnecting it from the speaker.

### Turning the Device On

1. Press and hold the [Power/Volume/Mode] wheel to turn on the speaker.  
 ♦ The front display will show [BT], and the LED under the [Power/Volume/Mode] wheel will light up.

### Turning the Device Off

1. With the power on, press and hold the [Power/Volume /Mode] wheel.  
 ♦ The text will disappear on the front display, and the LED under [Power/Volume/Mode] will also be turned OFF.

### Front Display

Different text will be displayed depending on the mode and context.

Text	Status
BT P	Bluetooth Pairing Standby
BT	Bluetooth Mode
FM	Radio Mode
AUX	External Device Connection
99.8 (e.g.,99.8)	Radio Channel
P 99.8 (e.g.,P 99.8)	Saved FM Frequency
TREB 0,1,2,3,4,5	Treble levels (0/1/2/3/4/5)
BASS 0,1,2,3,4,5	Bass levels (0/1/2/3/4/5)

### Connections

#### Connecting to a Mobile Device

1. When the product is powered on, it automatically enters Bluetooth Pairing Standby mode.
2. Turn ON the Bluetooth feature on your mobile device: [Settings > Connections > Bluetooth]
3. Select [ACRO BE100] when it appears in the device search to complete pairing with your mobile device.

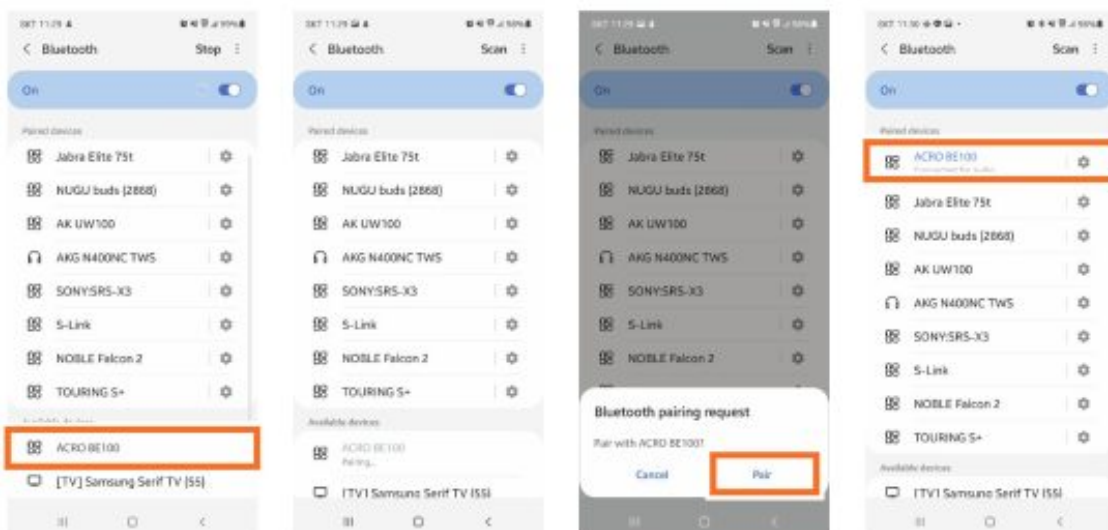

#### Entering Bluetooth Pairing Mode

Use this mode to connect the speaker with a device other than the currently paired mobile device on Bluetooth.

1. Press and hold the [Preset] button for 5 seconds or longer.  
 The front display will show [BT P], and it enters the Pairing Standby state.

**!** The connection image may vary depending on the connected mobile device and the version of the software. After pairing is complete, check the volume before using the speaker.

If Bluetooth pairing is not working, press and hold the [Preset] button for 5 seconds or longer to enter the Pairing Standby state.

When connecting the product to a device, make sure the product is located close to the device. Failing to do so may cause malfunction or noise depending on the user's environment.

Use the speaker within 10 meters of the connected device. The distance of separation may affect the quality of your wireless connection.

Make sure there are no obstacles between the product and the connected device. Obstacles including other people, walls, corners, supplementary partitions, etc., can affect the quality of your wireless connection. Make sure to use it in a location with no obstacles between the product and the connected device.

Be careful not to touch the device connected with the product. It may affect the quality of your wireless connection.

Bluetooth uses the same 2.4 GHz frequency band as industrial/scientific/medical/electronics devices and wireless LAN. This can cause interference between devices and affect the quality of the wireless connection.

## Basic Operations

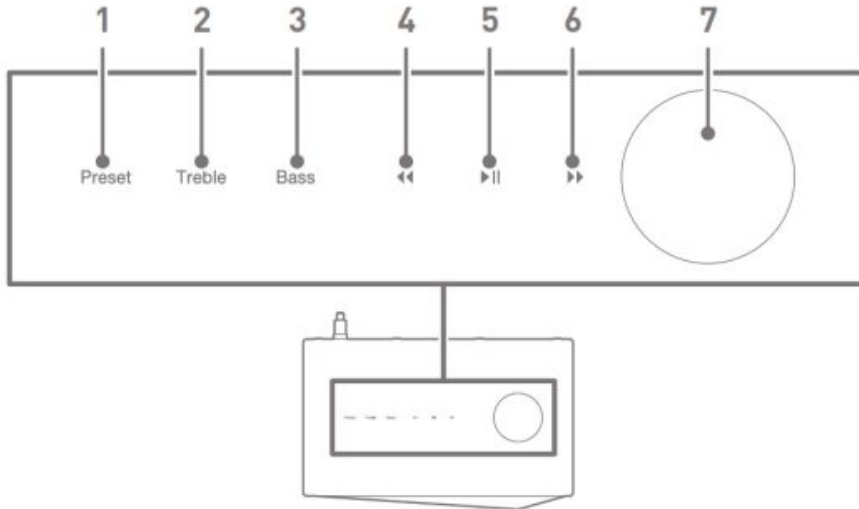

## Button Operations

1	Preset	Bluetooth Mode: Press and hold the [Preset] button for 5 seconds or longer to enter the Pairing mode. Radio Mode: You can save up to 6 channels of your choice.
2	Treble	Press the [Treble] button to adjust the treble level. Can be adjusted in 6 levels: 0>1>2>3>4>5
3	Bass	Press the [Bass] button to adjust the treble level. Can be adjusted in 6 levels: 0>1>2>3>4>5
4	Previous Song/ Channel	Bluetooth Mode: Go to the previous song. Radio Mode: Go to the previous channel.
5	Play/ Pause	Play/pause the music or radio.
6	Next Song/ Channel	Bluetooth Mode: Go to the next song. Radio Mode: Go to the next channel.
7	Power/ Volume/ Mode	Long press – Turn ON/OFF the product. Short press – Change the mode. Available in 3 modes: BT > FM > AUX Turn the wheel to adjust the sound volume.

**!** FM radio functions may vary depending on the model. Do not press the touch button with a pointed or sharp object. Doing so may cause the product to fail. For best operation, avoid touching the button too quickly. For best operation, touch the button accurately.

## Listening to Music

### Connecting to Bluetooth to Listen to Music

1. Press the [Power/Volume/Mode] wheel to set it to [BT] mode.

- ◆ The front display will show [BT].
- 2. After connecting the speaker and the mobile device via Bluetooth, you can play music through the speaker by playing it on the mobile device.
- 3. Use buttons on your mobile device or speaker to use features such as Pause, Play, Next Song, and Previous song.

### Connecting an External Device to Listen to Music

1. Press the [Power/Volume/Mode] wheel to set it to [AUX] mode.
  - ◆ The front display will show [Aux].
2. Connect the external device to the [AUX] port on the back with a cable that meets the product's specifications.
3. When you play music on an external device, the music is played through the speaker.



An audio cable for connecting to an external device is not provided with your product.

You can only connect an external device that supports

3.5mm audio output.

Turning up the volume too high may damage the speaker unit.

Depending on the music, listening to music for a long time at full volume can damage the speaker unit.

Max 2 Vrms is allowed for Aux-in.

### Listening to Radio

Listening to Radio

1. Press the [Power/Volume/Mode] wheel to set it to [FM] mode.
  - ◆ The front display will show [FM].
2. Press the [◀ / ▶] button to go to the desired frequency.
  - ◆ The front display will show the new frequency.
  - ◆ Pressing the [◀ / ▶] button moves the frequency in 0.1 MHz steps.
  - ◆ Press and hold the [◀ / ▶] button to find and go to an available frequency.
3. Pressing the [▶||] button pauses/resumes the radio.

### Saving a Radio Channel

Frequently visited radio frequencies can be saved through the preset feature.

1. Go to the desired frequency and press and hold the [Preset] button.
2. The current frequency will blink on the front display with P before the frequency, and the channel will be saved.
  - ◆ Up to 6 channels can be saved.

Listening to a Saved Radio Channel

1. In [FM] mode, press the [Preset] button to go to the saved channel.
  - ◆ The front display will show the frequency with [P].
2. Press the [Preset] button to navigate through the saved channels.
3. You can use [◀ / ▶] to go to a different frequency in the preset mode.

### Deleting a Saved Radio Channel

If you have saved all six presets and try to save a different frequency, the front display will show [FULL]. In this case, you must delete a stored preset to save the new channel.

1. Go to the frequency you wish to delete and press and hold the [Preset] button.
2. The current frequency will blink on the front display, the P before the frequency will disappear, and the channel will be deleted.



FM radio functions may vary depending on the model.

### Safety Precautions

#### Product

- Do not insert any metal objects (coins, hairpins, etc.) or flammable debris into the device.
- Do not place heavy objects on the product.
- If the product gets wet from rain (water), beverages, liquid medicine, cosmetics, sweat, or other moisture, do not turn it ON. Use a soft cloth to wipe the product dry and take it to a service center to be checked. (Failures due to water ingress can be repaired for a fee regardless of the warranty period, however, such damage may not be repairable.)
- Avoid exposing the device to direct sunlight or extreme temperatures (0°C – 40°C; 32°F – 104°F) such as the inside of a car during the summer.
- Do not store or use in hot and humid places such as saunas.
- Avoid places with excess moisture, dust, or smoke.
- Do not use for an extended period on blankets, electric blankets, or carpets.
- Do not place near a fire or in a microwave.

- Never attempt to disassemble, repair, or alter the product yourself.
- Do not place the device near magnetic objects (magnets, televisions, monitors, speakers, etc.). Never use harsh chemicals or detergents on the product as doing so can lead to changes in the surface and paint condition.
- Do not drop the product or expose it to a strong shock (avoid places with strong vibrations. etc.).
- Do not press multiple buttons simultaneously.  
Do not press the button too hard.  
Do not block the vent in the back where the sound comes out.  
Do not place a fire source such as a candle on the product.  
Do not install or use the product near heat-generating devices such as radiators, heaters, or stoves. Do not install the product in an enclosed space, bookcases, or similar places.

## Other

- Avoid using the device during thunderstorms to reduce the possibility of electric shock.
- Do not listen to music at an excessive volume for an extended period.

## Troubleshooting

### Common issues and solutions

1. The device won't turn on.
  - ◆ Please check whether the power adapter is connected properly.
2. Sound doesn't come out.
  - ◆ Check if the volume is set to [0].
  - ◆ Check the volume of the connected mobile device or external device.
  - ◆ Check the line-out settings in the connected external device.
3. The sound is distorted.
  - ◆ Check if the volume is too high.
  - ◆ Set the treble and bass levels again.
4. Cannot connect to Bluetooth.
  - ◆ Check the Bluetooth settings in the mobile device you want to connect.
  - ◆ Disconnect the mobile device from Bluetooth and try connecting it again.
  - ◆ Move the mobile device close to the product and try connecting it again.
  - ◆ Move away from devices such as microwave ovens and wireless network-related devices and try connecting it again.
5. The radio has noise.
  - ◆ Adjust the position and height of the antenna.
  - ◆ Move the product and check it again.

## Copyright

Dreams Company retains the rights to patents, trademarks, copyrights, and other intellectual property rights related to this manual. No contents of this user manual may be duplicated or reproduced in any format or by any means without the prior approval of Dreams Company. Using or reproducing, in whole or part, the contents of this document is subject to penalties. Software, audio, video, and any other copyrighted contents are protected in accordance with relevant copyright laws. The user accepts all legal responsibility for the unauthorized reproduction or distribution of the copyrighted contents from this product. Companies, organizations, products, people, and events used in the examples are fictional. Dream Company has no intention to be associated with any company, institution, product, person, or incident through this instruction book, and no such inference should be made. It is the responsibility of the user to comply with applicable copyright laws. Copyright © Dreams Company. All Rights Reserved.

## Certifications

KC / FCC / CE / TELEC

Class B Device (Communication equipment for residential use): This is a Class B Device and is registered for EMC requirements for residential use. This device can be used in residential areas and all other areas.



FCC ID: QDMDSM21

This device complies with Part 15 of the FCC Rules, Operation is subject to the following two conditions: (1) this device may not cause harmful interference, and (2) this device must accept any interference received, including interference that may cause undesired operation.

FCC Caution: Any changes or modifications not expressly approved by the party responsible for compliance could void the user's authority to operate this equipment. This device complies with FCC & IC radiation exposure limits set forth for an uncontrolled environment. This module may not be co-located with any other transmitters or antennas. The antenna must be installed such that 20cm is maintained between the antenna and users

## Registered Trademarks





LDAC and LDAC logo are trademarks of Sony Corporation.



Qualcomm® aptX™ HD

Qualcomm aptX is a product of Qualcomm Technologies, Inc. and/or its subsidiaries.

Qualcomm is a trademark of Qualcomm Incorporated, registered in the United States and other countries. aptX is a trademark of Qualcomm Technologies International, Ltd., registered in the United States and other countries.

## Disclaimers

The manufacturer, importer, and distributor shall not be liable for damages including accidental and personal injury due to the improper use or operation of this product. The information in this user manual was written based on current product specifications. The manufacturer, Dreams Company, regularly adds new features via OTA updates and will continue to apply new technologies in the future. Product specifications may be changed without prior notice. There is no warranty against data loss due to the use of this product.

## Specifications

Product Name	ACRO BE100
Product Type	Bluetooth Loudspeaker
Model Name	DSM21
Woofer Unit	4inch x1
Twitter Unit	1.5inch x2
Amplifier Output	55W(25W x1 + 15W x2)
Frequency Response	50 ~ 20kHz
Maximum Sound Level	94dB SPL @1m
Bluetooth Version	5
Bluetooth Codecs	SBC, AAC, aptX™ HD, LDAC
Indicators	14segment
Power Input	19V / 3,43A
AUX	3.5mm Stereo
Dimensions	261 x 164 x 171(mm)
Weight	about 3.2kg

## Documents / Resources



[Astell Kern Acro BE100 Bluetooth Wireless Speaker \[pdf\] User Guide](#)

Acro BE100, Bluetooth Wireless Speaker, Acro BE100 Bluetooth Wireless Speaker, Wireless Speaker, Speaker



## Related Manuals / Resources

[asimom EX70 Wireless Bluetooth Speaker User Manual](#)

EX70 Wireless Bluetooth Speaker

[POWERQI TB20 Wireless Charging Bluetooth Speaker User Manual](#)

TB20 Wireless Charging Bluetooth Speaker

[ZEALOT S67 Wireless Bluetooth Portable Speaker User Guide](#)

S67 Wireless Bluetooth Portable Speaker ZA-S67-20210906

[Asimom Wireless Bluetooth Speaker ASIMOM EX70 User Manual](#)

Asimom Wireless Bluetooth Speaker ASIMOM EX70 User Manual Asimom Wireless Bluetooth Speaker ASIMOM EX70 User Manual -

Optimized...



[Manuals+](#),

- [home](#)
- [privacy](#)